

DRG. No. W12GC006/3

DRG. REF.

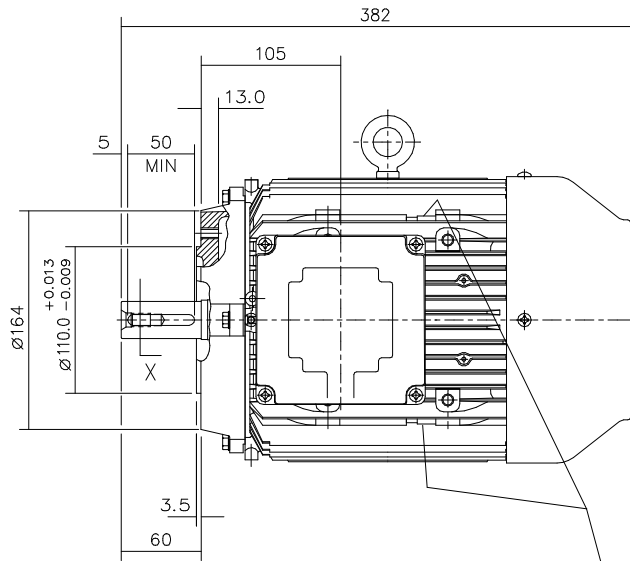

4 HOLES TAPPED M8  
THROUGH EQUI-SPACED  
ON A 130 P.C.D.

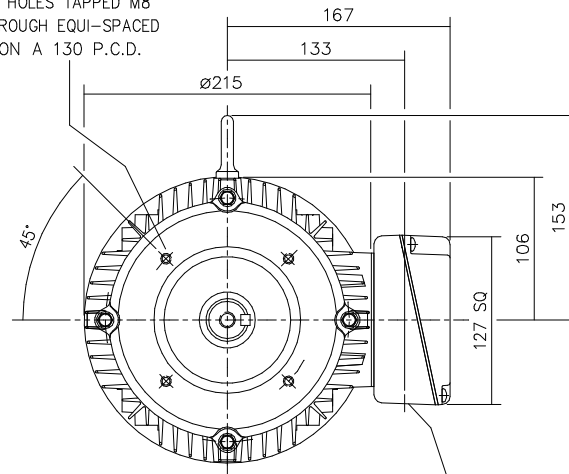

1 x CM25 CONDUIT ENTRY

M6 EXTERNAL  
EARTH

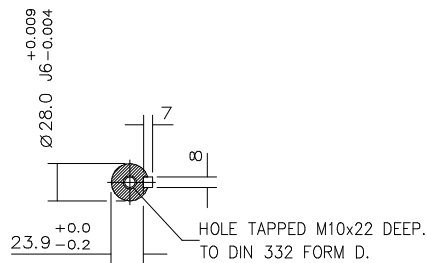

VIEW ON 'X'

CARE SHOULD BE TAKEN TO ENSURE THAT THE SCREWS OR STUDS DO NOT EXTEND INSIDE THE MOTOR BEYOND THE DEPTH OF THE TAPPED FIXING HOLE.  
 TERMINAL BOX POSITION:- CAN BE ARRANGED AT EITHER 9,12 OR 3 O'CLOCK.  
 STANDARD TERMINAL BOX POSITION IS 3 O'CLOCK AS SHOWN.  
 CONDUIT ENTRIES:- TERMINAL BOX CAN BE ROTATED AT 90° INTERVALS  
 (CONDUIT ENTRY POSITION SHOWN FOR ILLUSTRATION ONLY).

|                 |       |      |
|-----------------|-------|------|
| CUSTOMER        |       |      |
| ORDER No.       |       |      |
| PART No.        |       |      |
| OUR ORDER No.   |       |      |
| FRAME SIZE      |       |      |
| KW.             | RPM.  |      |
| Hz              | PHASE |      |
| VOLTS           | POLES |      |
| BRGS.           | DE.   | NDE. |
| MOTOR NETT WT.  | Kg.   |      |
| SPECIAL REMARKS |       |      |

ALL DIMENSIONS IN MILLIMETRES.

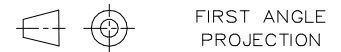

FIRST ANGLE  
PROJECTION

**BROOK  
CROMPTON**

Huddersfield, HD1 3LJ  
ENGLAND

SHEET TITLE  
SIZE OUTLINE DIMENSION DRAWING W ALUMINIUM TOTALLY ENCLOSED FAN COOLED  
A3 112M FRAME 'C' FACE MOUNTED MOTOR

|         |        |          |
|---------|--------|----------|
|         | NAME   | DATE     |
| DRAWN   | PAD    | 07-04-98 |
| CHECKED | DRM    | 07-04-98 |
| SCALE   | 1: 3.5 |          |

|           |            |      |          |
|-----------|------------|------|----------|
| DRG. No.  | W12GC006/3 |      |          |
| DRG. REF. | -----      |      |          |
| REVISION: | RR         | DATE | 04/06/03 |